

## FLOW INDICATOR

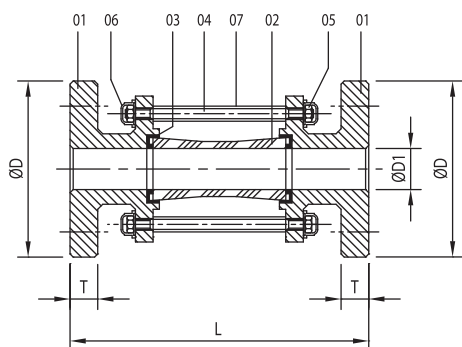

- MOC – PP (Polypropylene) / ISO-PP (Isotactic Polypropylene) / HDPE (High-Density Polyethylene) / PP-H (Polyethylene – Homopolymer) AND PVDF (Polyvinylidene Fluoride)
- Construction: 3-piece Design, Full Bore, Borosil Glass, Teflon Seated
- Design And Manufacturing Std.: As per the manufacturer's standard
- EEnd Connections: Flanged as per ANSI B 16.5 (ASA 150) & as per BS 10 (Table D/E/F) & DIN STD.
- Available Size: 1" (25 NB) to 6" (150 NB)

**Note: We will also provide alterations in: • SS 316 Parts • ISO-PP + SS • ISO-PP + PVDF. Valves may have our old “PARTH” brand logo.**

[illegible]



An ISO 9001:2015 Company

Parth brand owned by  
Parth Poly Fusion Pvt. Ltd.

# FLOW INDICATOR

SIZE		CODE	ØD	ØD1	L	T
IN.	NB					
1 "	25	P1FIN01	120.0	25.0	191.0	20.0
1 ½ "	40	P1FIN02	140.0	40.0	200.0	22.0
2 "	50	P1FIN03	165.0	50.0	220.0	24.0
2½ "	65	P1FIN04	182.0	63.5	255.0	24.0
3 "	80	P1FIN05	200.0	74.0	265.0	26.0
4 "	100	P1FIN06	226.0	99.0	281.0	28.0
6 "	150	P1FIN07	305.0	150.0	350.0	34.0
			Available On Request			
			Available On Request			

ALL DIMENSIONS ARE IN MM

( ±2 MM)

WORKING PRESSURE	
BODY	TEMP.
150 PSI	80° C



## PARTH POLY FUSION PVT. LTD.

New Survey No. : 1065/1, Opp. Viva - 2 Ind. Estate,  
Near Bhavda Gaam Canal, Bhavda, Ta: Daskroi,  
Dist : Ahmedabad, GJ, IN. Pin Code : 382433

## AEROCHEM PIPING PVT. LTD.

Plot No. 258, Road No. 1/B,  
Phase - I, Kathwada GIDC,  
Ahmedabad, GJ, IN. Pin Code : 382430

## CONTACT :

+91-9375112220  
sales@parthvalves.com  
www.parthfusion.com

Note: Every effort has been made to ensure the information in this brochure is correct at the date of issue. Parth Poly Fusion Pvt. Ltd. operates a policy of continual product improvement and range extension, hence reserves the right to modify product specifications, without prior information, in line with market requirements.