

MOULDED ELBOW 90°

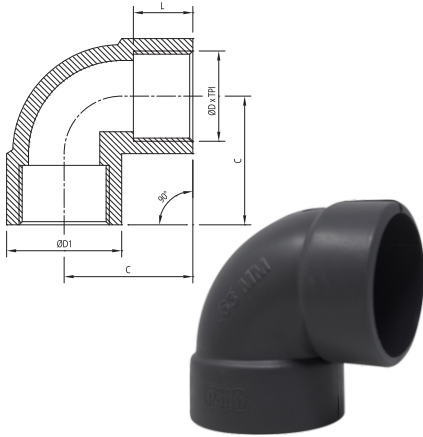

An ISO 9001:2015 Company

Parth brand owned by
Parth Poly Fusion Pvt. Ltd.



- Fitting Technology: Socket-Fusion Fitting
- MOC – PP (Polypropylene) / PPCP – NATURAL (Polypropylene – Copolymer) / ISO-PP (Isotactic Polypropylene) / HDPE (High-Density Polyethylene) / PP-H (Polypropylene – Homopolymer) and PVDF (Polyvinylidene Fluoride)
- As Per IS: 8008 – 1976 (PART III)
- Max. Working Pressure and Temp.: 10kg / cm² / 150 PSI and 80° C
- Available Size: ½" (20 MM), ¾" (25 MM) & 1" (32 MM)

Note: Fitting may have our old “PARTH” Logo

SIZE		CODE	C	ØD	ØD1	L
IN.	MM					
½ "	20	P1MES01	28.0	21.0	26.0	16.0
¾ "	25	P1MES02	33.0	25.0	31.0	19.0
1 "	32	P1MES03	39.0	32.0	41.0	20.0
1 ¼ "	40	P1MES04	48.0	41.0	48.0	22.0
1 ½ "	50	P1MES05	58.0	50.0	60.0	29.0
2 "	63	P1MES06	67.0	64.0	74.0	29.0
2 ½ "	75	P1MES07	79.0	76.0	88.0	37.0
3 "	90	P1MES08	96.0	91.0	105.0	42.0
4 "	110	P1MES09	111.0	110.0	127.0	50.0
6 "	160	P1MES10	170.0	161.0	180.0	85.0

All Dimensions Are In mm

(±2 MM)

As Per Is : 8008-1976 (part III)

Max. Working Pressure 10kg/cm²

WORKING PRESSURE	
BODY	TEMP.
150 PSI	80° C



PARTH POLY FUSION PVT. LTD.

New Survey No. : 1065/1, Opp. Viva - 2 Ind. Estate,
Near Bhavda Gaam Canal, Bhavda, Ta: Daskroi,
Dist : Ahmedabad, GJ, IN. Pin Code : 382433

AEROCHEM PIPING PVT. LTD.

Plot No. 258, Road No. 1/B,
Phase - I, Kathwada GIDC,
Ahmedabad, GJ, IN. Pin Code : 382430

CONTACT :

+91-9375112220
sales@parthvalves.com
www.parthfusion.com

Note: Every effort has been made to ensure the information in this brochure is correct at the date of issue. Parth Poly Fusion Pvt. Ltd. operates a policy of continual product improvement and range extension, hence reserves the right to modify product specifications, without prior information, in line with market requirements.